

A Closer look ...



Gravier St. parking garage and Walkway



Stanislaus Hall kitchen area



Stanislaus Hall study lounge



Two bedroom apartment living area



Two bedroom apartment kitchen



One bedroom apartment living area



Residence Hall lobby



Residence Hall recreational room



Residence Hall basketball court



Residence Hall study area

LSUHSC Student Housing Staff

Director of Student Housing
Harold H. Rihner

Coordinator of Student Housing
Katie G. Watson

Administrative Assistants
Kim Cain
Gloria Jefferson
Wanda Woodard
Karen Hurst

If you have any questions or would like more information about housing, please email us at:
aehousing@lsuhsc.edu

You may also access our website at:
<http://www.lsuhs.edu/administration/ae/housing.aspx>



Residence Hall Housing Office
1900 Perdido Street
New Orleans, LA 70112
Phone: (504) 568-6260
aehousing@lsuhsc.edu

Housing & Residence Life



Student housing at LSU Health Sciences Center—New Orleans is more than just a place to stay. It is where our students can live, study, learn, and grow while enjoying a living environment that offers support and assistance to maximize their educational opportunities. Both student housing facilities are designed for our



students to have a safe and convenient home while living on campus.

Stanislaus Hall



Shared bathroom



Dorm suite

Stanislaus Hall has 154 single occupancy dorm suites on 6 floors and is located at 450A South Claiborne Avenue. Each suite is furnished with a single bed (twin XL), wardrobe, entertainment center, computer desk, and desk chair. Toilet and shower facilities are shared with a suitemate.

All dorm suites have network connectivity.

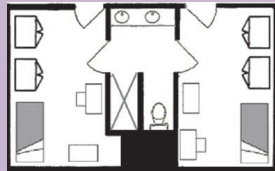

Common features on each floor are kitchens, laundry rooms, and study lounges also with internet connections. A covered, elevated walkway connects Stanislaus Hall to all campus buildings for easy and quick access to the Gravier Street parking garage, library, labs, classrooms, and cafeteria.

A modern, state of the art Wellness Center is situated on the third and fourth floors of Stanislaus Hall. The Wellness Center is dedicated to promoting the health and well being of the LSU Health Sciences Center community. Some of the amenities include weight lifting, cardio rooms, group exercise, and aerobics classes.

Residence Hall

The Residence Hall features three residence towers, containing 208 living units. Secure ground level parking below the building is available for tenants. Inside and outside recreational areas include table tennis, billiards, and a basketball court. Located at 1900 Perdido Street, the Residence Hall is connected to the Medical Education Building by a covered, elevated walkway for easy and quick access to classrooms, labs, library, and cafeteria.

The Residence Hall has living units that include:

- One-Bedroom Unfurnished Apartments
- Two-Bedroom Unfurnished Apartments
- Three-Bedroom Unfurnished Apartments
- Single Occupancy Dormitory Rooms

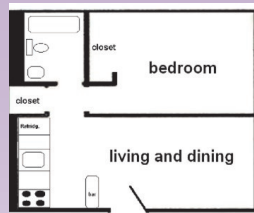

One bedroom 350 sq. ft.

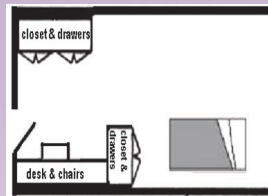

Single dormitory room 170 sq. ft.

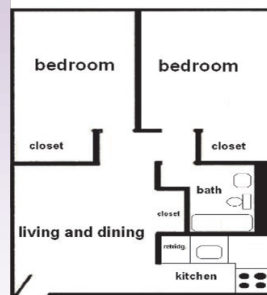

Two bedroom 520 sq. ft.



Three bedroom 700 sq. ft.

All of our apartments are unfurnished and include a full bathroom, kitchen range, and refrigerator.



One bedroom apartment kitchen



Apartment bathroom



Apartment living area



Apartment bedroom

Single dormitory rooms generally contain single beds (twin XL), built-in desks, chairs, and individual drawer and closet space. Dormitory rooms share a community kitchen, dining room, toilet, and shower facilities.



Single dormitory desk and closet



Single dormitory room

All apartments and dormitories are equipped with network connectivity. The laundry and lobby areas are always available for the convenience of the Residence Hall tenants.